



# OPERATORS MANUAL AH200 – AH300

ORIGINAL



ORIGINAL

### EY-VAATIMUSTENMUKAISUUSVAKUUTUS TUOTTEESTA

LLP Farm Machinery Group Oy vakuuttaa, että markkinoille saatettu kone täyttää direktiivin 2006/42/EY ja standardit SFS-EN ISO 12100 ja SFS-ISO730-1.

### FÖRSÄKRAN OM ÖVERENSSTÄMMELSE

LLP Farm Machinery Group Oy försäkrar härmed att tillförda maskin uppfyller maskindirektivet 2006/42/EY och standard SFS-EN ISO 12100 och SFS-ISO730-1.

### CERTIFICATE OF CONFORMITY FOR A PRODUCT

LLP Farm Machinery Group Oy certifies that the following machine, which has been brought into the market, conforms to directives 2006/42/EY and standards SFS-EN ISO 12100 and SFS-ISO730-1.

### SAMSVARSERKLÆRING FOR MASKIN

LLP Farm Machinery Group Oy bekrefter herved at følgende maskin, som er sendt ut på markedet, er i samsvar med direktivene 2006/42/EF, SFS-EN ISO 12100 og SFS-ISO730-1.

Tuote / Produkt / Product / Produkt: \_\_\_\_\_

Valmistusnumero / Tillverkningsnummer  
/ Serial number / Serienummer: \_\_\_\_\_

Teknisen tiedoston kokoaja / Teknisk  
dokumentation samlare / Technical file collector: Sakari Ruotanen

Valmistaja / Tillverkare / Manufacturer  
/ Produsent: LLP Farm Machinery Group Oy

Osoite / Adress / Address / Adresse: Levytie 4, FIN-74510 Iisalmi

Puhelin / Telefon / Telephone: +358 (0) 201 984 020

Paikka / Ort / Place / Sted: Iisalmi

Aika / Datum / Date / Dato: \_\_\_\_\_

Allekirjoitus / Underskrift / Signature  
/ Signatur: \_\_\_\_\_

Nimenselvennys / Namnförtydligande  
/ Clarification of signature  
/ Tydeliggjøring av signatur: Markku Lappalainen

## WARRANTY TERMS

All the products produced by LLP Farm Machinery Group Oy have twenty four (24) months warranty.

During the warranty period all the defects in material and in workmanship will be covered, in practical life FMG will replace defected parts with the new parts. Travelling expenses and freight of parts are not included in warranty.

Warranty will start in the beginning of usage of the product, if nothing else has been agreed.

Warranty is not covering damages due to misuse of product or use in the purposes where it has not been designed, lack of services or product has been modified without the permission of FMG.

Wearing of the normal usage is not covered by the warranty.

Losses in income, costs and loosen working hours caused by the defected part is not covered by the warranty.

Warranty repairs should be done by the FMG service dealer or service dealer appointed by the manufacturer.

In case the defects shown in reclamation is not valid or if case otherwise is not in the warranty area FMG has right to reject from the compensation.

Warranty reclamation should be done in written form by the FMG seller within one (1) month after notifying the defect.

In case of defect procedure is as follows:

- clarify the defect and defected area
- be prepared to deliver defected parts to the manufacturer
- contact FMG seller and make reclamation as follows:
  - type of the product and serial number
  - delivery date of the product (invoicing date)
  - date of the damage
  - description of the damage and pictures
  - description of the working conditions and the type of the base machine

## TO THE OPERATOR

The purpose of this manual is to provide support and instructions to sweeper users. Manual contains detailed instructions for driving, operating and maintaining the sweeper. Make sure that your new sweeper is always handled and maintained in the correct way in order to ensure reliability and economical operation for many years.

We recommend that you read the manual thoroughly. Follow the maintenance and service program carefully and include the daily maintenance in your normal routine. This is both you and your tractor interest.

Maintenance, repairs and adjustments which are not described in this Operator Manual require the use of special tools and exact technical data. In case of that kind need please contact your FMG seller or factory.

Use only genuine FMG spare parts for optimum performance from your tractor and sweeper. Spares will be sold through the FMG seller.

## TABLE OF CONTENTS

1. SAFETY INSTRUCTIONS.....	6
2. CONSTRUCTION.....	8
3. TECHNICAL SPECIFICATIONS.....	9
4. USE OF THE SWEEPER .....	9
4.1. Using area.....	9
4.2. Instructions .....	9
4.3. Working position .....	9
5. SERVICE .....	11
5.1. Daily service .....	11
5.2. Weekly service .....	11
5.3. Service after 500 hours .....	11
5.4. Annual service .....	11
5.5. Lubrication point .....	12
5.6. Screws to be tighten.....	13

## 1. SAFETY INSTRUCTIONS

This section summarizes the regulations that must always be followed when working with the sweeper. However, these regulations do not exempt the driver from statutory and other national regulations regarding traffic safety and occupational health and safety. Safety regulations that apply to different types of working sites and existing road traffic laws must always be observed. Tractor safety regulations accepted by the Finnish occupational safety and health administration have already been taken into account in the equipment design. The following section describes general safety precautions that must be observed regarding the use of the sweeper.



### IMPORTANT

**Do not use the sweeper for other purposes than it has been designed. Please read this manual carefully before using the implement.**



### IMPORTANT

**Before driving, make sure that all movements and functions work correctly.**



### DANGER

**When testing different movements of the sweeper make sure that there is no one close to tractor. Safety distance 5 meters.**



### IMPORTANT

**Advise other users on the use of the implement and ask them to read the manual.**



### DANGER

**Do not operate a faulty implement.**



### IMPORTANT

**Use the rotary beacon while working.**



**WARNING**

Observe the manufacturer's instructions while working.



**WARNING**

Pay attention to other road users.



**IMPORTANT**

Always lower the implement and stop the engine before leaving the cab.



**IMPORTANT**

Never service or clean an implement that is resting on the hydraulics. Use mechanical support. Always stop the engine for maintenance.



**WARNING**

Do not disconnect, connect or tighten pressurized hydraulic plugs.



**WARNING**

Do not inhale oil mist if a pressurized component becomes damaged. If oil comes into contact with the eyes, rinse with plenty of water and contact a doctor immediately.

## 2. CONSTRUCTION

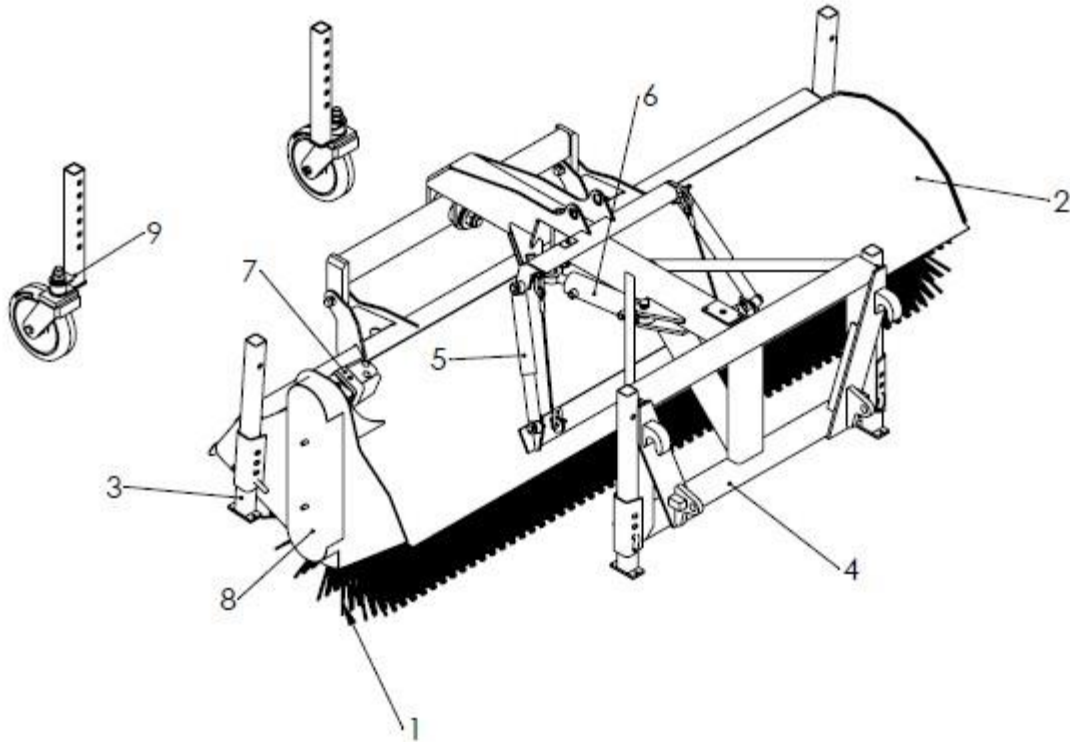

1. Sweeper disc
2. Sweeper frame
3. Stand
4. Attaching frame
5. Shock absorber
6. Turning cylinder
7. Hydraulic motor
8. Chain box
9. Rear and front support wheels (option)



### 3. TECHNICAL SPECIFICATIONS

Model	Width (cm)	Height (cm)	Working width (cm)	Brush dia (cm)	Weight (kg)	Min. pump capacity (l/min)
AH200	225	110	200	70	420	55
AH240	265	110	240	70	440	55
AH260	285	110	260	70	460	55
AH300*	330	135	300	90	590	70

\*AH300 has two hydraulic motors

Maximum turning angle of the open sweeper is +/-28 degree

### 4. USE OF THE SWEEPER

#### 4.1. *Using area*

Mechanical open sweeper is intended for large and small areas and roads cleaning. Open sweeper is really a multiuse equipment which is able to use in sand, dust, snow, leaves... sweeping.

#### 4.2. *Instructions*

Before use take care that sweeper is correctly engaged and all the locking's are completely done.

Test drive and take care that sweeper is working completely. In case of repairs in hydraulic or if sweeper is new take care that hydraulic doesn't do any impetuous movements.

When working, take care that sight to the sweeping area is clean and there are nobody in that area.

When disengage sweeper put shields to the hydraulic couplings.

In case of leaving sweeper to the outdoor storage take care that ground is balanced to help next engage. Piece of wood would be helpful in that case.

#### 4.3. *Working position*

Adjust sweeper that ends of the sweeper lamella meet ground (Picture 1). Too much press in the sweeper lamella leads to over wearing and shorter life time.

Adjust the sweeper so that the floating is in middle position, then chain box is in a horizontal position.

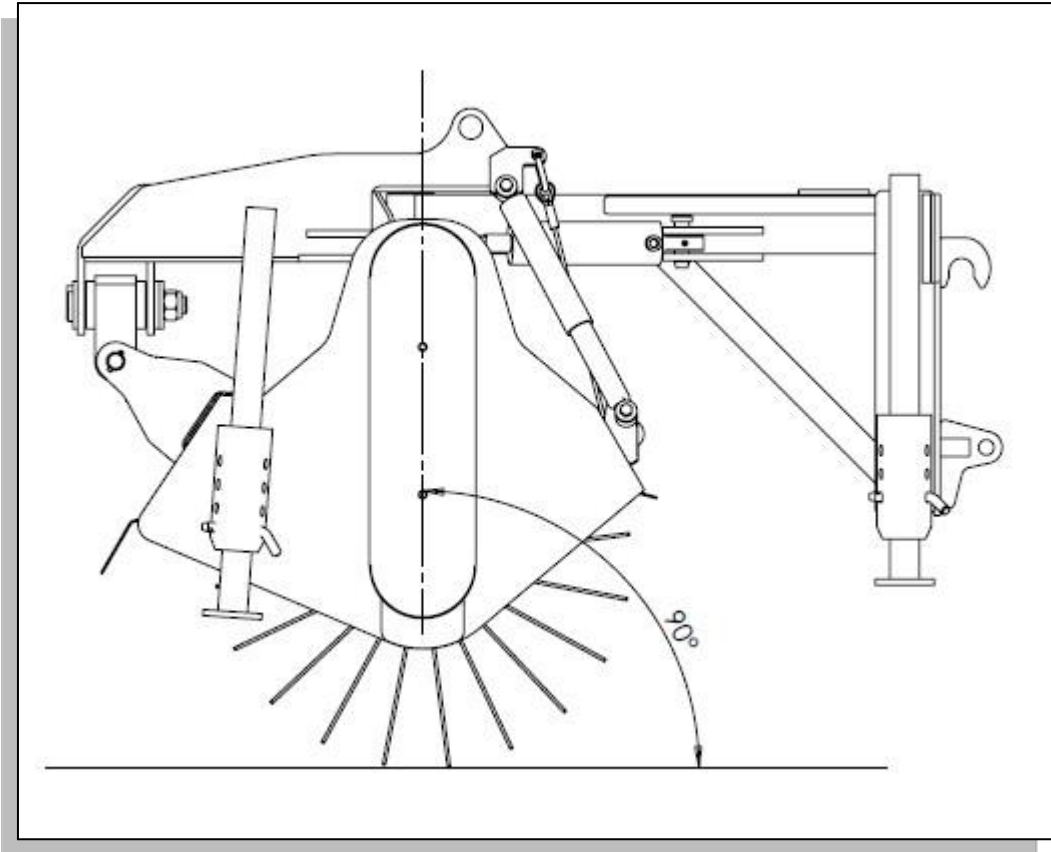

**Picture 1. Working position**

Use the sweeper according to the driving direction (Picture 2).

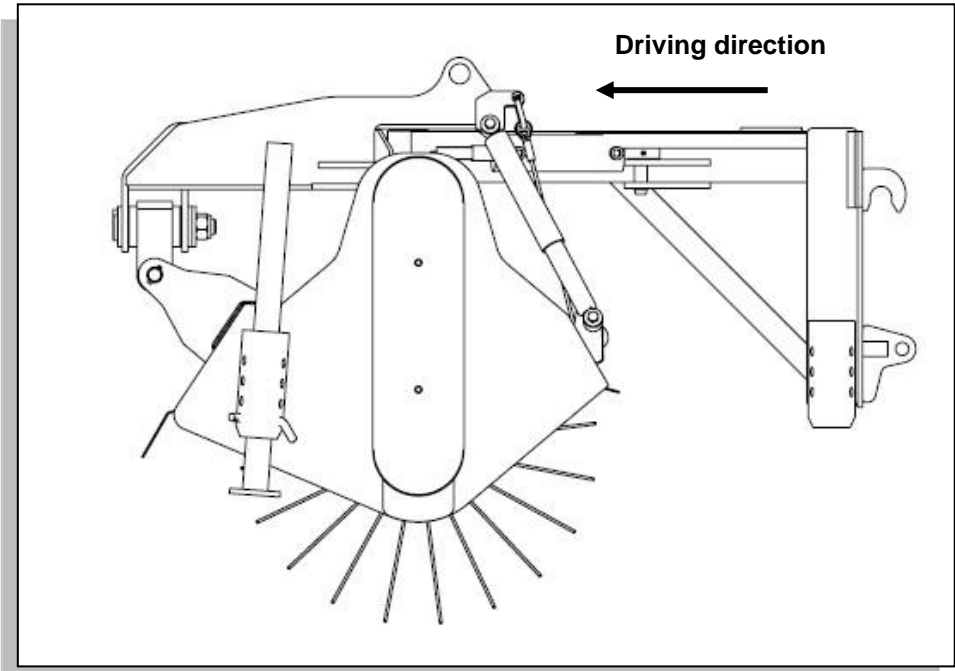

**Picture 2. Driving direction**



**NB!**

**During using the sweeper, pay attention to free floating both in driving and sideways direction**

## **5. SERVICE**

Good service is one of the most important things to keep high reliability when working. Service is economical compared to different kind of reparations. Service below includes all the lubrications, adjustments and checking's.

### **5.1. Daily service**

- Check all the movements
- Clean sweeper in the end of the every working day

### **5.2. Weekly service**

- Grease the roller chain of the sweeper every 40 hours, tighten if necessary.



**NB!**

**Do not over-tighten.**

- Grease the sweeper bearings
- Grease the turning bar joints and the cylinder pins
- Check the hydraulic plugs for leaks

### **5.3. Service after 500 hours**

- Check all the pins
- Check the tightness of the screws

### **5.4. Annual service**

All above mentioned. Lubricate nozzles when leaving sweeper to the storage.



**NB!**

**When serving, all the services mentioned here must be done.**



**NB!**

**Tightness of the screws must be checked also after the first drive.**

### 5.5. Lubrication point

Lubricate nozzles shown in the picture on a weekly basis (Picture 3.) Clean top of the nozzle before lubrication.

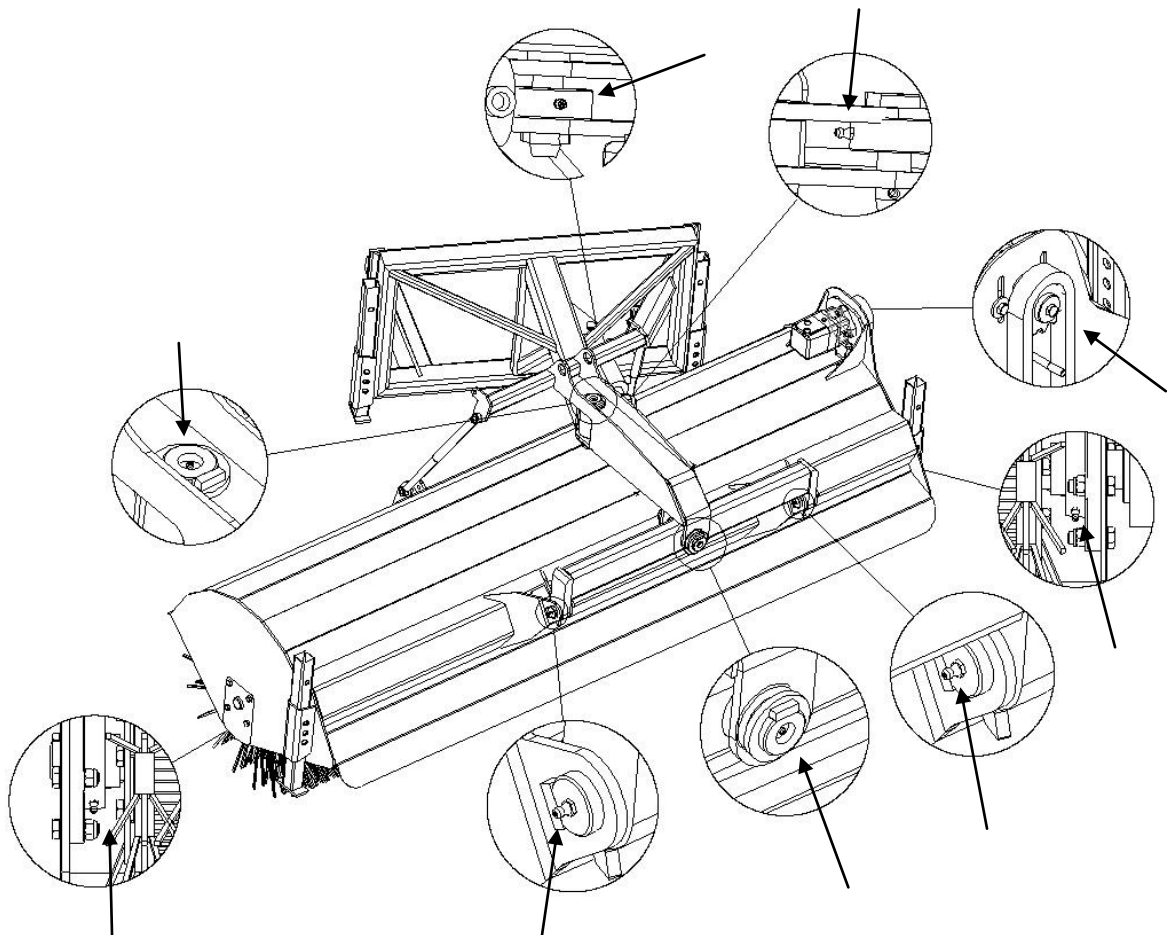

### 5.6. Screws to be tighten

Tighten all the screws and nuts after the first 10 hours` drive and after that after 500 hours.

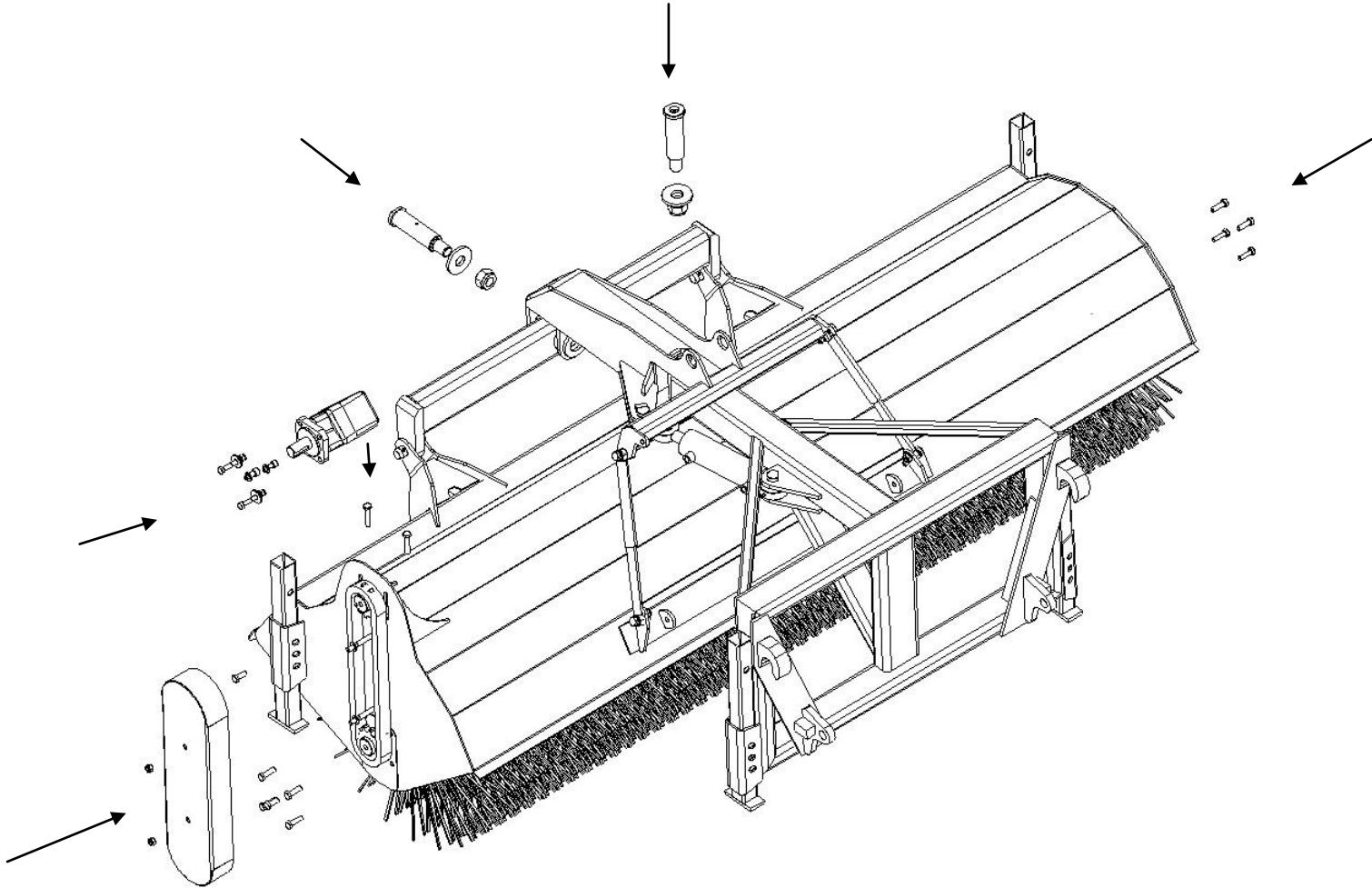



**LLP FARM MACHINERY GROUP OY**

LEVYTIE 4  
74510 IISALMI, FINLAND

PUH. +358 (0)20 1984 020  
FAX +358 (0)20 1984 029

[www.fmg.fi](http://www.fmg.fi)

